



T-34 MENTOR
OPERATIONAL
MANUAL

1. Introduction

Congratulations on purchasing the T-34 Mentor and getting into the exciting world of radio control flight. The T-34 is designed as the perfect transitional trainer to help beginning pilots move beyond basic flight. Its four-channel setup gives you full control of throttle, rudder, elevator and ailerons. The flat-bottom airfoil and large wing-area-to-weight ratio provide excellent stability and aerobatic performance.

Specifications:

- Wingspan: 880mm, 34.65"
- Fuselage length: 760mm, 29.92"
- Flying weight: 450g, 15.87oz
- Servos: 3 micro servos
- Battery: 11.1V 1100mAh 15C
- Motor: 1530KV Brushless Outrunner

Parts Included:

- Fuselage
- Main Airfoil
- Horizontal Stabilizer/Elevator
- Vertical Stabilizer/Rudder
- Landing Gear
- Propeller and Spinner
- Manual

2. How to Assemble

1. Remove the covering from the two-sided tape on the tail section.
Press horizontal stabilizer lightly into place, then secure it with a screw.

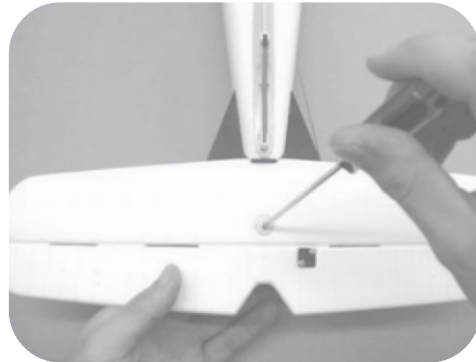

2. Install vertical stabilizer and secure with a screw.





3. Connect pushrod wires to elevator and rudder.

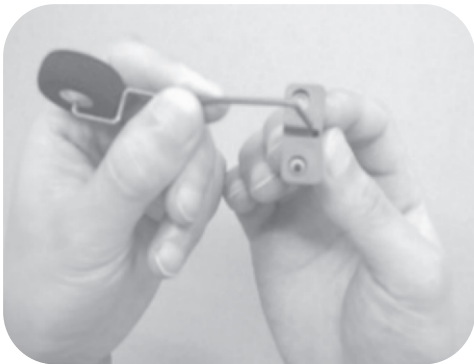

4. Install front landing gear. Use screws to secure to front of fuselage.

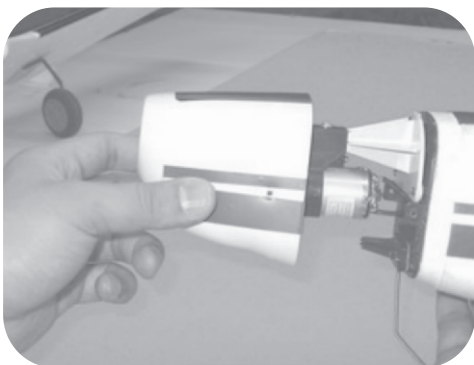

5. Install cowling and tighten screws.

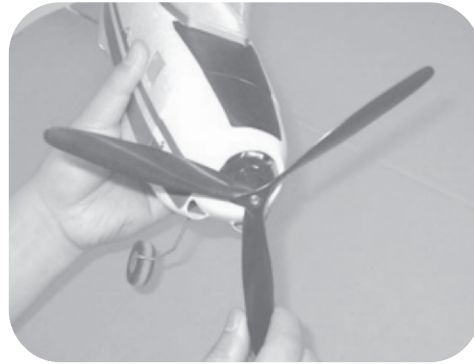

6. Attach propeller and spinner.

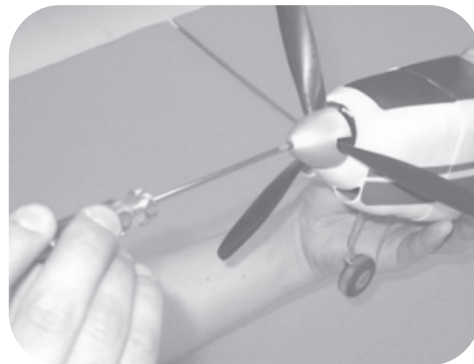

7. Install rear landing gear.
Attach to underside of main wing.



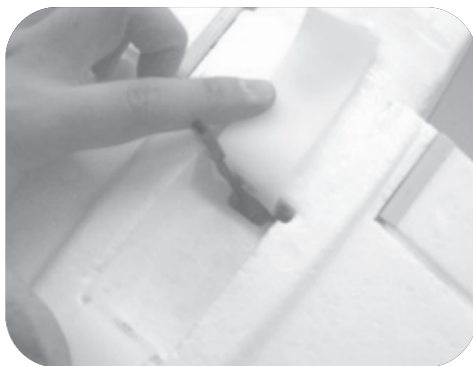

8. Pull ESC connector through bottom of fuselage so that it protrudes from the battery tray.

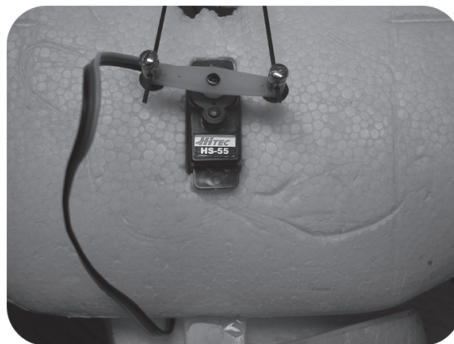
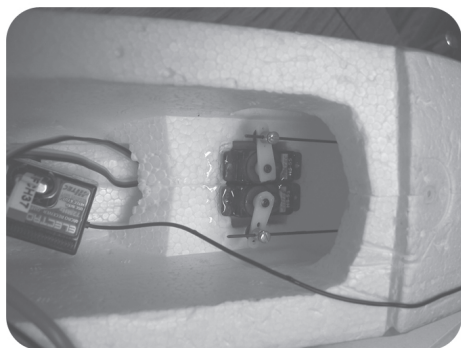

9. Install rudder and elevator servos in center of fuselage and aileron servo on top side of main wing. Secure all servos with glue.



10. Slide main wing into slots behind the cowling, then secure with a screw.

10. Plug battery into ESC and install in battery compartment.

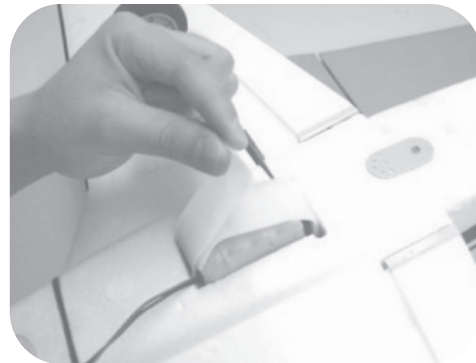

Center of gravity should be 3 3/8" back from leading edge of wing, measured from where wing meets fuselage.

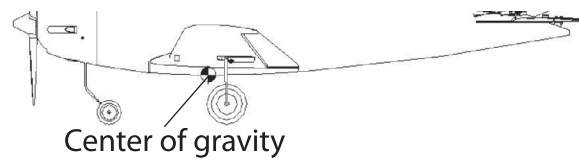

If a Crash Occurs

If you happen to crash and part of the foam wing or tail breaks, it can be repaired using packing tape to cover missing pieces. If damage is severe or if the wing or tail is bent, replace damaged parts immediately. Replacement parts are available for all components.

Warnings and Safety Checklist

1. Read and follow this manual, observing all instructions and safety directions. If you do not do this, serious injury and damage can occur. Think safety first.
 2. Keep propeller away from all body parts at all times! Beware of loose clothing or hair becoming entangled in the propeller.
 3. Never fly when it is too windy or you may lose control of the airplane. Never fly near people, vehicles, train tracks, buildings, power lines, water, hard surfaces, or trees, and never attempt to catch the airplane.
 4. Adult supervision is recommended for ages 12 and under.
 5. Only use a battery charger intended for use with the airplane battery. Never leave the charger unattended while charging! During charging, place the battery and charger on a heat-resistant surface. Do not place them on carpet or upholstery.
 6. Never cut into the battery charger or airplane wires, or serious injury can occur. Causing the battery to short out (crossing negative and positive bare wires) can cause a fire, serious injury and damage.
 7. Hold the plane securely, and keep all body parts away from the propeller at all times.
 8. After you have finished flying, or at any time you have the radio system on, ALWAYS unplug the battery prior to turning the transmitter off. ALWAYS turn on the transmitter prior to plugging flight battery in.
 9. Never fly on the same frequency as another RC vehicle in your area. Doing so will cause you, or the other person, to lose control of the plane.
-

Tips for Success

1. Do not fly in winds over 7 mph, especially during first flights. Flying in too much wind is by far the number one reason for crashes and flyaways.
2. Choose the flying area carefully. A grassy field or soft ground that is about 600 feet in diameter is optimum. It's also best to fly in an area with very few or no trees.
3. ALWAYS fly the airplane UPWIND! Never allow your airplane to fly too far down wind, as it will get farther and farther away from you. If you find that the plane has gotten down wind, reduce throttle and point the nose directly into the wind to bring it back closer to you.
4. Wear sunglasses on sunny days.
5. Avoid flying directly overhead.
6. Always make sure the flight battery is fully charged immediately prior to flying.
7. Do not attempt maneuvers beyond your abilities.